

Griddle and Hot Plate Parts - Budget (8,9 & 10 Series)

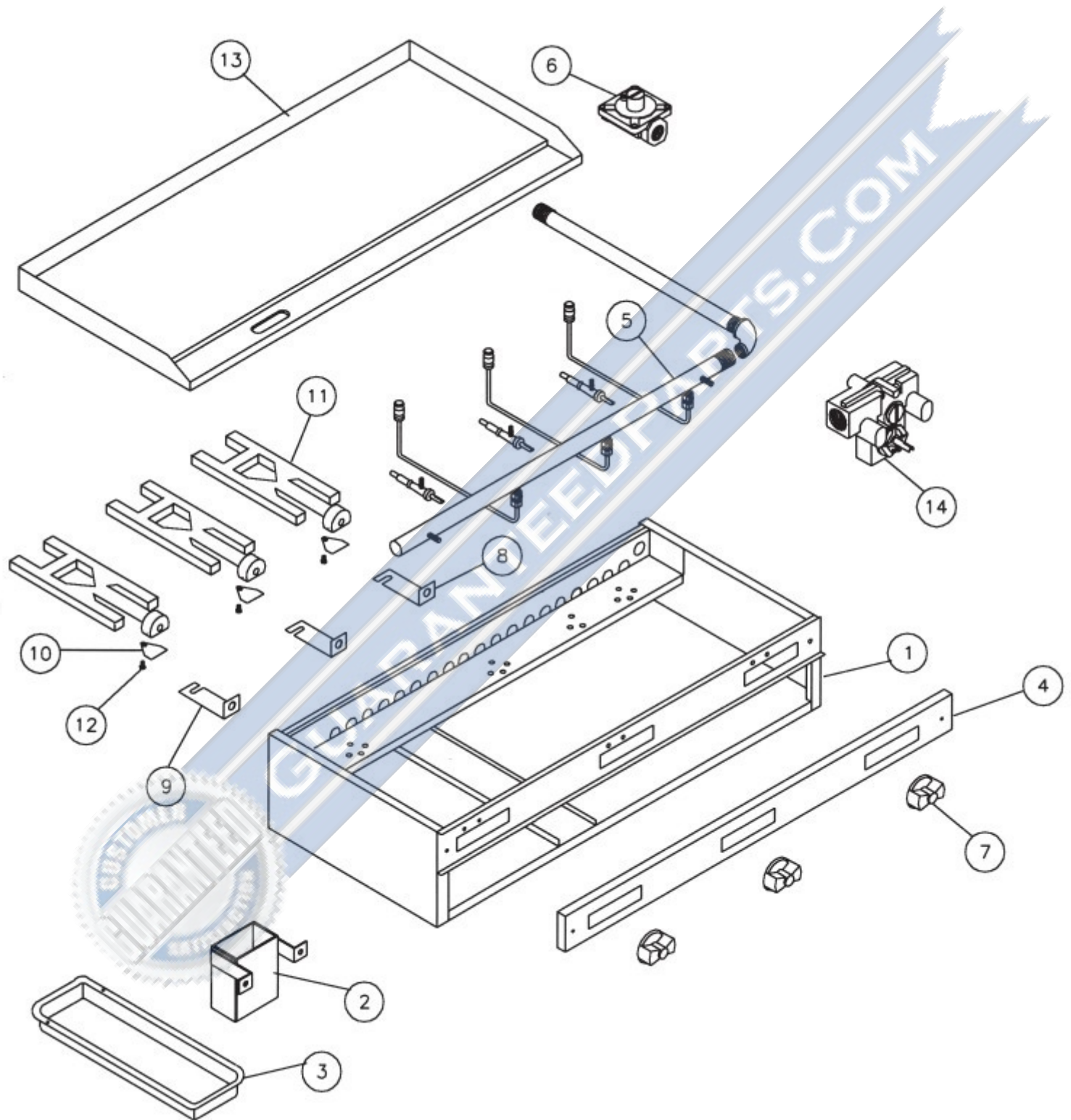

Part No.	Diagram Part #	Description
25001		Valve, Manual Gas (#18) Flat Up
25001-51		Assy; Manual Gas Valve W/#51 Orifice - NG
25001-58		Assy; Manual Gas Valve W/#58 Orifice - LP
17033		Control, GS Thermostat (200-400 Degrees)
16014		Burner, Cast Iron 'H' Small
16015		Assy., Cast Iron "Y" Tube Burner
16016M		Base, Cast Iron Machined Burner
16017AL		Ring, Burner Cap
V15-10		Grate, 10" Stainless Steel Top
16034		Grate, Spider Ring Top
17006N		Adjustable Pressure Regulator - Natural
17006L		Adjustable Pressure Regulator - LP
18030		Knob, Big, On-Off, Manual - F Series - Blue
18008		Knob, GS Thermostat, Black (200-400)
EG101		Grease Drawer, EG Series
V104-A		10 Series Grease Chute Assembly



GUARANTEED PARTS.COM